

September 27, 2019

Manpreet Singh
Vill. Ralli, PO Datas
Mansa, , 151502

Student ID: 110023806
Person Access Code (PAC): 707259
DLI: O19358946722

Dear Manpreet,

Congratulations! We are pleased to offer you admission to the University of Windsor in the following graduate program:

Academic Program (Level of Admission): Master of Applied Computing (Master's Candidate (M2))

Academic Program Start Date: Winter 2020

Enrollment Status: Full Time

This offer of admission is made provided that you meet the following conditions:

- (i) maintain a competitive average for entrance to the above program and,
- (ii) submit the following item(s) by the required Due Date(s).

Conditions and Provisions:

Transcript(s):

Confirmation of degree completion must be received by the Office of the Registrar-Graduate Division by the stipulated deadline. Documents must be received directly from your institution or delivered in a sealed envelope issued by your institution.

Date Due: April 1, 2020

Final transcripts indicating all courses & grades must be submitted prior to the end of the first academic semester. Documents must be received directly from your institution or delivered in a sealed envelope issued from your institution to the Office of the Registrar-Graduate Division.

Date Due: April 1, 2020

Other Requirements:

Scholarships, graduate/teaching assistantships or research assistantships are not available for students accepted to this program.

Must present your valid student study permit to the International Student Centre (Laurier Hall 2nd floor) by the last day to add courses within the first term of registration.

To reserve your place in this program you must **confirm your acceptance of this Offer of Admission by October 18, 2019.**



Additional Information:

Please ensure that you have sufficient funds to meet all of your needs before accepting this offer.

Program fees and Term Start Dates: This information can be found at <https://www.uwindsor.ca/gradprogfee> while a tuition fee estimator is also provided at <http://web2.uwindsor.ca/finance/fee-estimator/>.

Living Expenses: A reasonable minimum estimate for a graduate student with no dependents is \$10,000 per year (\$14,000 per year if have one dependent). These expenses are in addition to tuition (does not include compulsory incidentals), books, and health insurance.

Housing and Accommodation: The University of Windsor offers on-campus housing and meal plans; additional information is provided at <https://www.uwindsor.ca/residence>.

International students please note: This is your official, final letter of acceptance. Please present this letter to apply for your study permit. This letter has been issued electronically.

Sincerely,

Patricia Weir

Dean, Faculty of Graduate Studies
University of Windsor



International Cohort Based Masters Admissions

Office of the Registrar

apply@uwindsor.ca

Congratulations on your admission to the University of Windsor's Professional Program!

The next step is to confirm your offer of admission. Please login to the University's electronic Graduate Application System (eGAS) at www.uwindsor.ca/its/eiss/egas. Once you have printed your offer of admission letter, you can prepare to apply for your visa, bank loan, search for living accommodations and begin making travel preparations.

Program Terms and Conditions

- To secure your place in the program, you must accept the offer of admission through your eGAS account. The offer will expire 21 days from the date on the offer of admission letter. You must also submit a deposit of **\$4000.00 CAD**. The deposit is due 21 days from the date issued on the offer of admission. If you do not provide a deposit by the due date you will not be guaranteed a seat in the class. Payment should be made via www.uwindsor.ca/finance/student-accounts. Payment will be applied to your first term program fees and is refundable only with adequate proof of a refused Student Visa. See the University of Windsor website for the refund policy.
- ELIP fees can be taken from this deposit; however, students will be required to replenish the deposit to \$4000.00 CAD before registering for courses.
- By accepting this offer of admission, you are also agreeing to register for the University Health Insurance Plan.
- All conditions on your offer letter associated with this offer must be satisfied before the due date indicated.
- This letter of offer is non-transferable. Payment of program fees and/or remittance of program deposit cannot be applied to any other program offered by the University of Windsor.

Condition(s) of Admission

- Transcripts: Please forward an official copy of all post-secondary education transcripts to the Office of Graduate Admissions by the indicated due date. Transcripts must be received by Graduate Admissions in the original sealed envelope from the granting institution(s) to be considered official. The mailing address is as follows:

University of Windsor
Office of the Registrar - Graduate Studies Division
401 Sunset Ave.
Windsor, Ontario, N9B 3P4

- Degree Confirmation: Please forward an official copy of your degree confirmation/proof of completion of all post-secondary education to the Office of Graduate Admissions (address above) by the listed due date. The Degree Confirmation must be received in the original sealed envelope from the granting institution to be considered official. An attested copy of the original certificate would be accepted if received in the original sealed envelope from the granting institution.

- English Proficiency Test Score: Please request the testing centre to send your results directly to the University of Windsor. Our institution code is 0904. Please note that the language requirements of the program must be met prior to attendance in any courses at the University of Windsor.
- English Language Improvement Program (ELIP): If you do not meet the language requirements of your academic program, you can register for language training at the Centre for English Language Development at the University of Windsor. You will not be able to begin any coursework until all language requirements of the program are met.

You must register for ELIP at uwindsor.ca/englishlanguagedevelopment.ca. Direct inquiries can be directed to applyesl@uwindsor.ca.

- Study Permit: You must submit your study permit to our International Student Centre, located in Laurier Hall on the University of Windsor Campus. You can do this when you arrive in Windsor.

Tuition Information and Program Length

- There is a section at the end of your offer of admission letter with "additional information". This section provides a link to a page that lists your tuition information and program length required for your visa application as well as an approximation of living expenses. The Offer of Admission letter can be used to apply for a visa/study permit and a bank loan. This page also lists the semester start dates.

Additional Information and Helpful Links

- The International Student Centre provides many great benefits to students through their Soft-landing program, Multi-faith Space, VISA and work permit assistance and social events. Please visit their website for more information at www.uwindsor.ca/isc.
- Residence Services offer many different housing and meal plan options. You need to apply in advance, so you are encouraged to visit their website early www.uwindsor.ca/residence.
- The University of Windsor's Student Alliance (UWSA) maintains links to information about off-campus housing. You can visit their website at www.uwsa.ca.
- Campus Recreation facilities as well as varsity and intramural sports. For more information, please visit their website at www.uwindsor.ca/athletics.

For further information please email your respective department:

- Engineering: mengprog@uwindsor.ca
- Automotive: auto@uwindsor.ca
- Management: management@uwindsor.ca
- Education- International Cohort: edugrad@uwindsor.ca
- Applied Computing: macprogram@uwindsor.ca
- Medical Biotechnology: trantum@uwindsor.ca
- Actuarial Science: hlynka@uwindsor.ca
- Applied Economics and Policy: jayrhee@uwindsor.ca

Welcome to Residence



RESIDENCE IS SO MUCH MORE THAN JUST A PLACE TO LIVE.

Residence offers you the chance to be a part of a community that fosters an environment of personal growth while supporting your efforts to become an academically and socially responsible individual. Our focus in residence is life outside of the classroom and we make it easy for you to get involved! You can participate in events, work as a desk services staff, or serve on a residence committee.

Living in residence means you're not alone when you need help. Resident Assistants (RA) help you transition to university life, make friends, and become a part of the Lancer community. We also have full-time staff here to support you who live on campus and who are on-call 24/7.

Living on campus puts you just steps away from classes, Lancer events, social activities and dining halls, making it easy for you to fully experience campus life.

24/7

Academic and personal help on hand

900+

Possible friendships



LIVING LEARNING COMMUNITIES

Live with students who share your academic program. This allows you to connect with your classmates, join them for studying, work on group assignments, or attend social events. Our current offerings include Engineering, Nursing and Science Communities.



CHOICE OF ROOMMATES

A preferred roommate can be requested. Both students must identify each other on their residence application. If a roommate is not specified, you will be matched based on preferences selected on your residence application.



SPECIAL CONSIDERATIONS

A limited number of rooms are available to students who require special accommodations. We make every effort to place students in rooms that best meet their needs. For more information, please visit uwindsor.ca/residence



BOOKSTORE PLAN

For greater convenience, you can add a Bookstore Plan to your Student ID Card. The Bookstore Plan is an optional add-on to your Residence fees. For more information, please visit uwindsor.ca/residence



MEAL PLANS*

Residence students are required to choose a meal plan from a variety of options, with values ranging from \$4,800 to \$5,500. *You may use the meal plan to pay for food at all outlets on campus as well as several nearby restaurants. For more information, please visit uwindsor.ca/food

** Meal Plan rates are based on 2019-2020 and are subject to change for 2020-2021*



RESIDENCE GUARANTEE

Accommodations are guaranteed for first-year students (coming directly from high school) who apply and submit a \$475 deposit by the guarantee date (see website). After that date, you can still apply and room assignments are based on availability and on a first come, first serve basis.

Students may apply to residence before accepting their offer of admission to the University of Windsor, however, please see the Residence and Meal Plan Licence Agreement for details on the cancellation/withdrawal policy.

Note: An offer of residence does not constitute an offer of acceptance to an academic program.

** Information on these pages are subject to change.*



uwindsor.ca/residence 519.253.3000, ext. 3279 resservices@uwindsor.ca



University of Windsor



SAFE &
SECURE



SUPPORT
SERVICES



ON CAMPUS &
STEPS AWAY
FROM CLASSES



WIFI INCLUDED

RESIDENT
ASSISTANTS



CLOSE
COMMUNITY



LESS MEAL PREP



FURNITURE
INCLUDED



Your Home Away From Home

BUILDING AMENITIES*

- 24-hour secured building access
- Kitchens or microwave rooms
- Laundry facilities
- Common lounges with cable TV
- Study rooms

*Amenities may vary by building

WE PROVIDE:

- Bed, mattress, armoire or closet, desk, chair, study lamp, and fridge
- Wireless internet
- Telephone landline with voicemail, call display and call forward.

AFTER FIRST YEAR, YOU'RE WELCOME TO COME BACK TO RESIDENCE!

Return to Residence and you will be guaranteed a single room — and you can choose the room if you apply by the deadline date. You can apply to return to Residence every year you are a student.

MACDONALD HALL \$6,185 - \$7,426*

Double and limited single rooms • Twin beds • Common bathrooms • Traditional style • Student lounges • Study rooms • Science & Engineering Living Learning Communities • First Year Students (coming directly from high school)

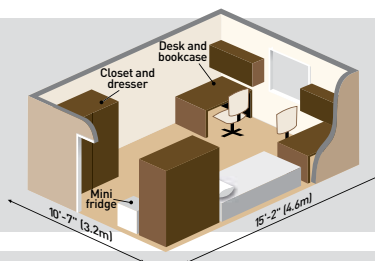
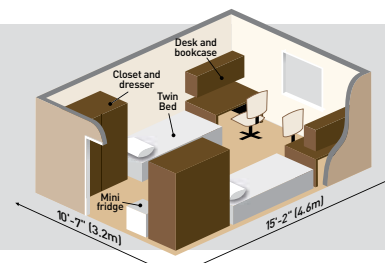

LAURIER HALL \$7,426*

Single rooms • Twin or double bed • Common bathrooms • Traditional style • Student lounges • Study rooms • Beyond-First Year Students • Home to the International Student Centre

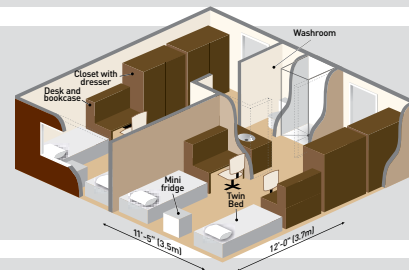

CARTIER HALL \$7,114*

Double rooms • Twin beds • Semi-Private Bathroom • Open atrium • Main floor student lounge • Study rooms • First Year Students (coming directly from high school)

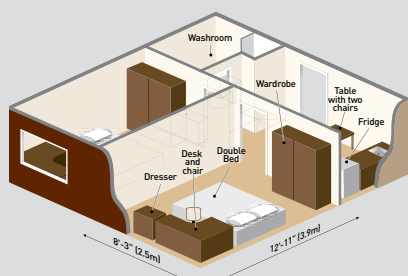

ALUMNI HALL \$8,164*

Two-Bedroom suites • Double beds • Kitchenette • Semi-Private Bathroom • Student lounges • Nursing & Engineering Living Learning Communities • GPA required for first-year students only • Beyond First Year & First Year Students (coming directly from high school) • The Bru Convenience store

*Compulsory and non-refundable fees are included in residence fees. All fees are based on 2019-2020 and are subject to change for 2020-2021. Information on these pages are subject to change.



uwindsor.ca/residence 519.253.3000, ext. 3279 resservices@uwindsor.ca



University
of Windsor



University
of Windsor



ENGLISH LANGUAGE IMPROVEMENT PROGRAM

The English Language Improvement Program (ELIP) is UWindsor's pathway to meeting language requirements for entry to your academic program.

A valid English language assessment score determines which ELIP level you will take and the number of ELIP terms you will need to complete before beginning academic study. Each ELIP term is 12 weeks. Successful completion of ELIP 3 qualifies for entry to academic study.

If you have an overall IELTS and writing band score of:	5.0	5.5	6.0 +	Begin your academic program
You will begin in level:	ELIP 1	ELIP 2	ELIP 3	
# of ELIP terms you will need to complete before academic start:	Three	Two	One	

If you do not have an English language assessment score, we can conduct a placement test when you arrive.



LEARN MORE & REGISTER
www.uwindsor.ca/elip

CONTACT US:



www.uwindsor.ca/elip



applyesl@uwindsor.ca



+519.253.3000 x3425 or x3405