

January 12, 2024

Dear Gaganpreet Singh .,  
*Student ID: 2024011672*

## Congratulations!

It is our pleasure to offer you admission into the Bachelor of Business Administration (BBA) (Project Management) program, July 2024 term at Yorkville University. We can't wait to welcome you to our British Columbia campus!

At Yorkville University, you will be joining a vibrant and diverse community of faculty, staff and students who, like you, are seeking life-changing transformation through education. Our aim is to inspire you to learn and grow over the course of your studies at Yorkville.

## Next Steps

This letter contains all the information you need to know about **your program, fees and bursary**. Please refer to the following pages for more details.

Please note this is **not** the final version of your acceptance - the official Letter of Acceptance and receipt will be issued by the International Admissions Office at Yorkville University after receiving your tuition deposit and after final confirmation that all university documents and admission requirements have been met in full. Yorkville University reserves the right to request additional information pertaining to your eligibility for admission and rescind this Preliminary Letter of Acceptance if that request is not fulfilled.

A receipt and official Letter of Acceptance are required as part of your study visa application to Immigration, Refugees and Citizenship Canada (IRCC). Yorkville University will contact you in advance of your start date and will provide a link to your New Student Registration Form as well as your Plan of Study. Please note that students are required to register for courses in advance of the commencement of their program. **All international students will be automatically enrolled in a mandatory health insurance plan through Yorkville University.**

Should you have any questions, please contact your Admissions Advisor: Angelina Barswal, [abarswal@yorkvilleu.ca](mailto:abarswal@yorkvilleu.ca)

Thank you for choosing to study at Yorkville University. We look forward to seeing you on campus!



Ted James  
Registrar  
Yorkville University

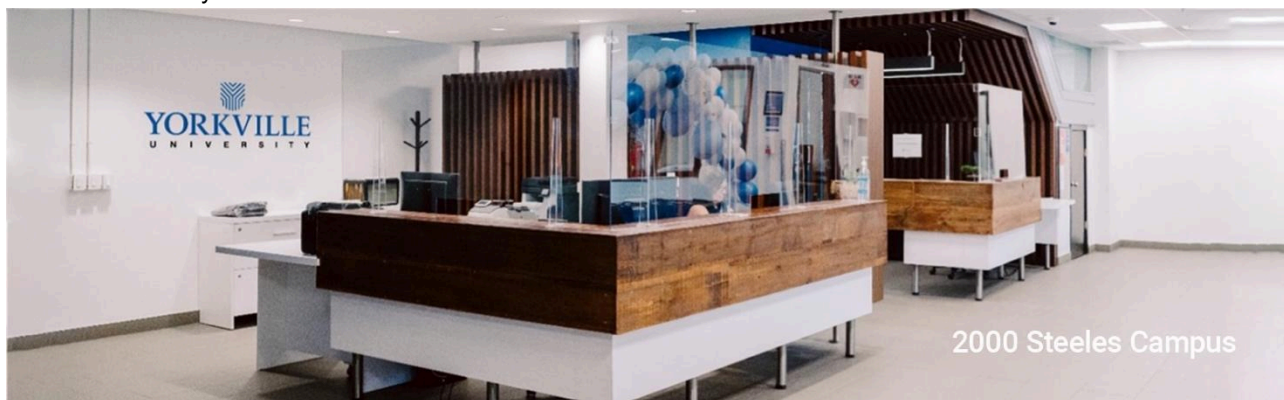

## Your Program

**Student Name:** Gaganpreet Singh .  
**Student ID:** 2024011672  
**Program Name:** Bachelor of Business Administration  
**Start Date:** July 2024  
**Expected Completion Date:** January 2028

For more information on your program, please refer to our website:

<https://www.yorkvilleu.ca/programs/bachelor-of-business-administration-oncampus/>

## Your Fee Breakdown (in Canadian dollars CAD)

ESTIMATED 1 <sup>st</sup> YEAR FEES <sup>1</sup> (incl pro-rated bursary)	\$15,000.00 <sup>2</sup>
ESTIMATED TOTAL PROGRAM FEES (excl bursary)	\$77,160.00 <sup>2</sup>
BURSARY	\$10,000.00 <sup>3</sup>
FEE DEPOSIT DEADLINE	20 days <sup>4</sup> from the receipt of the preliminary admission letter.
FEES DUE	\$15,000.00 <sup>2</sup> (including non-refundable \$500)
PAYMENT PORTAL	ApplyBoard payment portal <sup>5</sup> – <a href="#">click here</a>

1. An academic year consists of 9 months (3 terms). Yorkville University programs offer 4 terms in a calendar year.
2. Fees are estimated at the 2023-2024 rate. Fees may be increased annually. Annual increases are scheduled for the October start date and typically fall between 4-6%. Changes to tuition rates will be announced at least 3 months prior to the start of the term to which they apply. Current tuition rates are available on the University's website. The costs mentioned above do not include other fees such as books, expendable supplies, health insurance or cost of living. **If program fee or bursary changes are made prior to the start of the program, an incremental charge to the student may occur.**
3. This bursary is automatically applied to any courses where the student pays full tuition and international fees. Students with transfer credits will receive a prorated bursary amount distributed across their remaining courses. **The organization reserves the right to change how and when the bursary is distributed over the duration of the program.**
4. Failure to submit a deposit within 20 days of receiving this letter may result in students being required to reapply or being placed on a waitlist with no assurance of enrolment.
5. Students paying the fee deposit from a Canadian financial institution should contact ApplyBoard directly for instructions on how to submit their payment.

## Refund Policy

By paying your fee deposit through the ApplyBoard Payment Portal (either directly by yourself or by a third party such as an education agent), you accept and agree to ApplyBoard's terms and conditions:

- All amounts paid by you to the school will be applied towards your tuition and other applicable fees once you have started your studies. Please note that subject to jurisdictional regulations, your fee deposit may be non-refundable unless you are refused a study visa or provide IRCC proof of visa cancellation, in which case your fee deposit will be refunded to the source from which it originated. **Subject to jurisdictional regulations, a \$500 CAD administrative fee may be deducted from any amounts refunded to you.** If you have attended class and withdraw after the first week of term one due to visa refusal or other reasons, your tuition will be charged for the number of attended days.

## Your Bursary

By paying your fee deposit and international fee, you are eligible for a maximum of **\$10,000 bursary**, which will be applied to your tuition account in the following manner. The bursary values assume you will study 12 credits (4 courses) a term and will complete 36 credits (12 courses) in your first three terms. In the event that a full 4-course term is not studied each of the first three terms, there will be a true-up in the final term of study to ensure that the student receives a full \$10,000 bursary over 120 credits. **For all students, the university reserves the right to change the weighting and payment timing of the \$10,000 bursary.**

Term 1	\$2,716.00	Term 6	\$264.57
Term 2	\$2,716.00	Term 7	\$264.57
Term 3	\$2,716.00	Term 8	\$264.57
Term 4	\$264.57	Term 9	\$264.57
Term 5	\$264.57	Term 10	\$264.57
<b>Total Bursary: \$10,000.00</b>			

**Note: For all students, the university reserves the right to change the weighting and timing of the \$10,000 bursary and/or make program fee changes. Students with transfer credits will receive a prorated bursary amount distributed across their remaining courses.**

## Your Estimated Tuition Schedule

As of the 2023-2024 rate, the following is the estimated tuition schedule for students receiving a \$10,000 bursary. Actual tuition fees are assessed prior to the start of each term and may differ.

Term 1	\$5,000.00	Term 6	\$7,451.43
Term 2	\$5,000.00	Term 7	\$7,451.43
Term 3	\$5,000.00	Term 8	\$7,451.43
Term 4	\$7,451.43	Term 9	\$7,451.43
Term 5	\$7,451.43	Term 10	\$7,451.43
<b>Total Estimated Tuition (incl \$10,000 bursary): \$67,160.00</b>			

**Note: For all students, the university reserves the right to change the weighting and timing of the \$10,000 bursary and/or make program fee changes.**

## Your Estimated Living Costs

On average a student should budget between \$1,500 and \$2,500+ CAD per month.

For more information about the cost of living in **Vancouver**, please visit <https://www.costofliving.workbc.ca/>

Please also ensure you have accommodation arranged for yourself before you leave to come to Canada. We have a partnership with **4stay** to offer students a variety of housing and affordable rooms around the campus. Learn more by visiting [4stay](#).

**All international students will be automatically enrolled in a mandatory health insurance plan through Yorkville University.** Please visit <https://www.studyinsured.com/yorkvilleu> for more information.



January 12, 2024

Dear Gaganpreet Singh .

*Student ID: 2024011672*

It is with great pleasure that I am writing to congratulate you on your offer of admission into Yorkville University's Bachelor of Business Administration (Project Management).

Please find attached to this email the Preliminary Letter of Acceptance and instructions for the payment of your tuition deposit.

By paying your tuition deposit through the ApplyBoard Payment Portal (either directly by yourself, or by a third party such as an education agent), you accept and agree to ApplyBoard's terms and conditions:

- All amounts paid by you to the school will be applied towards your tuition and other applicable fees once you have started your studies. Please note that, subject to jurisdictional regulations, your fee deposit may be non-refundable unless you are refused a study visa or provide IRCC proof of visa cancellation, in which case your fee deposit will be refunded to the source from which they originated. Subject to jurisdictional regulations, a \$500 CAD administrative fee may be deducted from any amounts refunded to you. If you have attended class and withdraw after the first week of term one due to visa refusal or other reasons, your tuition will be charged for the number of attended days.

Here is essential information to help you get ready to start your studies:

- **Conditions:**
  - Students who have not scored at least C grade in their Grade XII Mathematics examination are required to take MATH0910: Developmental Math and to earn at least a C grade.
  - Applicants who score below 6.5 in IELTS but 6.0 or higher will be admitted on a language proficiency condition that they pass ENGL180 (English for Academic Purposes) which will be offered in their first term of studies
- **Credit Transfers:** If you have completed courses at the post-secondary level please submit official course outlines (translated in English). You may be eligible for transfer credits. Additional transfer credit assessments will be assessed upon receipt of a tuition deposit.
- **Documents Required:** At this time, the following documents have not been received: Official IELTS Report Form, Official Senior Secondary School Certificate, Study Permit. Please forward any outstanding documents to your Admissions Advisor as soon as possible. These documents are required before you start your program.

Please note this is **not** the final version of your acceptance - the official Letter of Acceptance and receipt will be issued by the International Admissions Office at Yorkville University after receiving your tuition deposit and after final confirmation that all university documents and admission requirements have been met in full. Yorkville University reserves the right to request additional information pertaining to your eligibility for admission and rescind this Preliminary Letter of Acceptance if that request is not fulfilled.

A receipt and official Letter of Acceptance are required as part of your study visa application to Immigration, Refugees and Citizenship Canada (IRCC). Yorkville University will contact you in advance of your start date and will provide a link to your New Student Registration Form as well as your Plan of Study. Please note that students are required to register

for courses in advance of the commencement of the program. All international students are required to enroll in a health insurance plan through Yorkville University.

We look forward to having you join us in the Bachelor of Business Administration (Project Management).

A handwritten signature in blue ink, appearing to read 'Ted James', with a stylized, cursive script.

Ted James  
Registrar  
Yorkville University



## Pre-Offer Letter

ApplyProof date / date de ApplyProof: January 12th, 2024 / 12 janvier 2024

Verify Document

Vérifier le document

### HOW TO VERIFY DOCUMENT / COMMENT VÉRIFIER LE DOCUMENT

EN

To verify this document, click the button on the top right or go to [applyproof.com](https://applyproof.com) and enter the **ApplyProof Code** and **Passcode**

Or copy the link into your browser:  
[applyproof.com/FDE5A594](https://applyproof.com/FDE5A594)

**APPLYPROOF CODE**  
**FDE5 A594**

FR

Pour vérifier ce document, cliquez sur le bouton en haut à droite ou allez sur [applyproof.com](https://applyproof.com) et entrez le **Code ApplyProof** et le **Passcode**

Ou vous pouvez aussi copier ce lien dans votre navigateur:  
[applyproof.com/fr/FDE5A594](https://applyproof.com/fr/FDE5A594)

**PASSCODE**  
**2004/11/08**

Have more questions? Visit our [FAQ page](#). / Vous avez d'autres questions? Visitez notre [page FAQ](#).